

Veterinary Immunofluorescence Quantitative Analyzer



FINECARE PLUS VET—YG-102

User-centered design, simpler and more professional

Operating system upgrade, support Wi-Fi data transmission and mobile data management

● Reliable

- Rapid and accurate, good correlation with CLIA method
- Full traceability
- QC available
- Built-in temperature control

● Easy-To-Use

- Support whole blood, serum, and plasma
- Portable, LCD touch screen, multi-lingual
- Built-in thermal printer

● Professional Data Management System

- Support WIFI data transmission and mobile data management
- HIS/LIS connectivity

● Various Application Scenarios

- Laboratory, hospital, clinic, etc.

● Competitive

- 10 μ L of the sample at least, result in 3~15 min
- Full test line, cost-efficient
- Store & operate at room temperature, 24 months expiry period for reagents

PROCEDURE

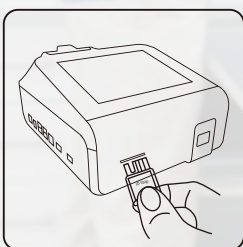

Load ID card

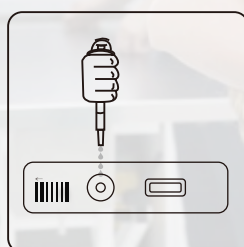

Add samples to the test card

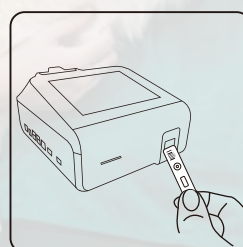

Insert the card into the device



Read the results(3-15 min)

Category	Cat. No.	Test Item	Sample Volume	Reaction Time	Linear Range	Reference Range
Hormone	V403	T4	75µL	15min	6~120nmol/L (0.47~9.32µg/dL)	Canine 15~60nmol/L(1.2~4.7µg/dL) Feline 15~50nmol/L(1.2~3.9µg/dL)
	V404	TSH	75µL	15min	0.1~200mIU/L (0.005~2.56ng/mL)	Canine 0~37mIU/L(0~0.68ng/mL) Feline 0~21mIU/L(0~0.32ng/mL)
	V405	Cortisol(COR)	75µL	15min	10~1000nmol/L (0.36~36.23µg/dL)	16.6~166nmol/L(0.6~6.01µg/dL)
	V402	Canine Prog (cProg)	75µL	15min	1~50ng/mL (3.18~159nmol/L)	10~20ng /mL(31.8~63.6nmol/L)
Diabetes	V407	HbA1c	Whole blood 10µL	5min	4.5%~14.5%	3%~4.5%
FDPS	V406	D-Dimer	Whole blood 15µL /Citrate plasma 10µL	5min	100~10000ng/mL	0~250ng/mL
Pancreatitis	V408	cPL	10µL	10min	50~2000µg/L	< 200µg/L
	V409	fPL	75µL	15min	0.5~50µg/L	< 3.5µg/L
Renal Biomaker	V412	cCys-C	10µL	10min	0.1 ~ 10mg/L	< 1.2mg/L
	V413	fCys-C	10µL	10min	3~30mg/dL	< 7mg/dL
	V434	SDMA	10µL	5min	5~100µg/dL	Canine 0~14µg/dL(0~16µg/dL in puppies) Feline 0~14µg/dL
Cardiac	V410	cNT-proBNP	75µL	10min	150 ~ 6000 pmol/L	< 800pmol/L
	V411	fNT-proBNP	75µL	10min	50 ~ 1000 pmol/L	< 150pmol/L
	V437	c-cTnl	75µL	15min	0.1-30 ng/ml	< 0.3 ng/mL
	V436	f-cTnl	75µL	15min	0.1-30 ng/ml	< 0.3 ng/mL
Inflammation	V400	Canine CRP (cCRP)	10µL	3min	2~250mg/L	0~10mg/L
	V401	Feline SAA (fSAA)	10µL	3min	2~300mg /L(µg/L)	0~8mg/L(µg/L)
	V435	Equine SAA (eSAA)	10µL	10min	20-3000 mg/L	< 50mg/L
Feline Triple Antibody Test	V430	FCV Ab	10µL	10min	0.5~200U	< 0.5U level 0; 0.5~4.0U level 1; 4.1~9.0U level 2 9.1~20.0U level 3; 20.1~30.0U level 4 30.1~60.0U level 5; >60.0U level 6
		FPLV Ab	10µL	10min	0.5~100U	< 0.5U level 0; 0.5~2.5U level 1; 2.6~5.0U level 2 5.1~10.0U level 3; 10.1~20.0U level 4 20.1~40.0U level 5; >40.0U level 6
		FHV Ab	10µL	10min	0.5~250U	< 0.5U level 0; 0.5~10.0U level 1; 10.1~20.0U level 2 20.1~30.0U level 3; 30.1~40.0U level 4 40.1~100.0U level 5; >100.0U level 6
Immuno	V429	ICH Ab	10µL	10min	0.5~1200U	< 0.5U level 0; 0.5~2.0U level 1; 2.1~60.0U level 2 60.1~100.0U level 3; 100.1~400.0U level 4 400.1~600.0U level 5; >600.0U level 6
		CPV Ab	10µL	10min	0.5~30U	< 0.5U level 0; 0.5~1.0U level 1; 1.1~2.5U level 2 2.6~5.0U level 3; 5.1~10.0U level 4 10.1~20.0U level 5; >20.0U level 6
		CDV Ab	10µL	10min	0.5~100U	< 1.0U level 0; 1.0~2.0U level 1; 2.1~5.0U level 2 5.1~10.0U level 3; 10.1~20.0U level 4 20.1~50.0U level 5; >50.0U level 6
V428	* RV Ab	10µL	10min	0.2~10 IU/mL	0~0.5IU/mL low level	
Infectious Diseases	V423	CCV Ag	Fecal sample 75µL	10min	/	Positive: Infected with the virus; Weak positive: Low viral loads; It is suspected to be in the early stage of infection or the phases of detoxification, please make a comprehensive diagnosis based on clinical symptoms. Negative: No infection.
	V424	CDV Ag	Conjunctival secretion sample 75µL	10min	/	
	V425	CPV Ag	Fecal sample 75µL	10min	/	
	V427	FCoV Ag	Fecal sample 75µL	10min	/	
	V426	FPV Ag	Fecal sample 75µL	10min	/	
	V431	FHV Ag	Conjunctival secretion sample 75 µL	10min	/	
	V432	FCV Ag	Conjunctival secretion sample 75 µL	10min	/	

Sample Type: Whole blood/serum/plasma. It is recommended to use serum or plasma, except for HbA1c, D-Dimer (whole blood).

Level 0: Immunization is recommended;
Level 1 and 2: Low titer antibodies in the body;
Level 3 and 4: Medium titer antibodies in the body;
Level 5 and 6: High titer antibodies in the body;

* Ongoing: RV Ab, FeLV Ag, FIV Ab

Wondfo | Wondko

No. 8 Lizhishan Rd., Science City,
Huangpu District, 510663, Guangzhou, P.R. China

E-mail: wondfo-vet@wondfo.com.cn

Web: www.wondko.com

Tel: +86-020-32293661